

KSK 6BC-SW-SS

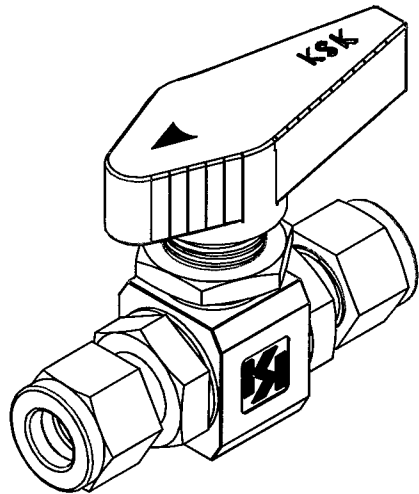
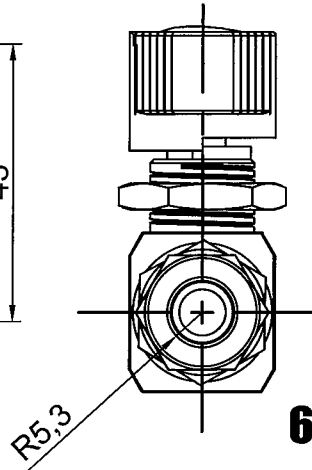
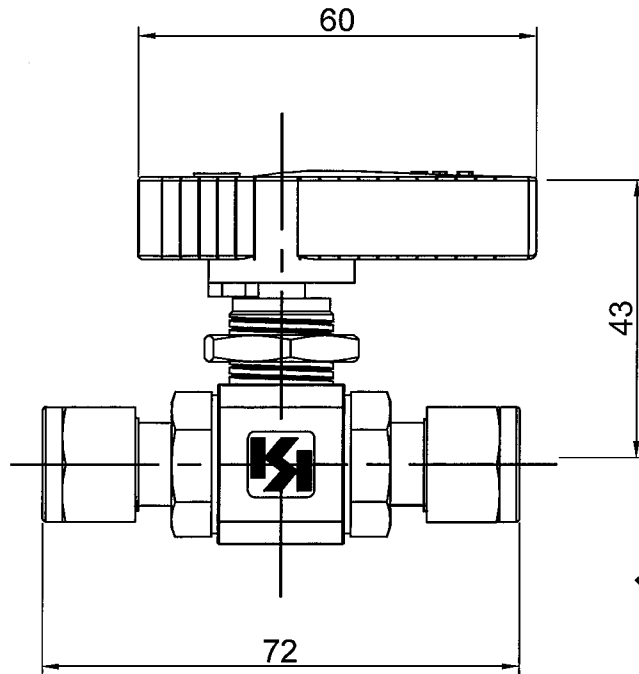
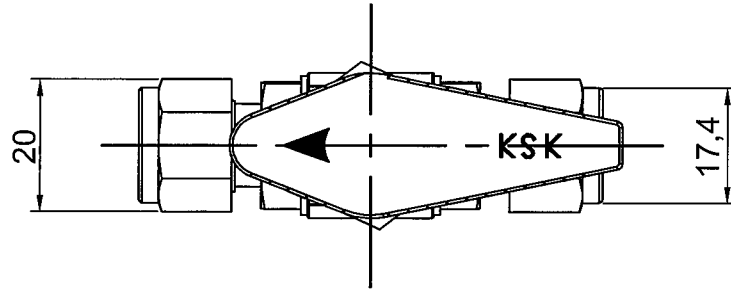

SPECIFICATION	
BODY SIZE	3/8"
END CONNECTION	LET-LOK / FU-LOK
MAX.WORKING PRESSURE	5.1Mpa
WORKING TEMP.RANGE	-10 to 80...°
HELEAK	INBOARD
	CROSS THE SEAT
	≤ 1.0 x 10 ⁻⁶ atm.cc/sec He
	≤ 1.0 x 10 ⁻⁶ atm.cc/sec He

UNIT : mm

ITEM	PARTS	Q.TY	MATERIALS
1	BODY	1	CF8M
2	CAP	2	SUS 316
3	BALL	1	SUS 316
4	BALL SEAT	2	PTFE
5	CAP O-RING	2	VITON
6	STEM	1	SUS 316
7	THRUST WASHER	1	PTFE
8	STEM PACKING	1	PTFE
9	GLAND NUT	1	SUS 316
10	HANDLE	1	POM
11	PANEL	1	SUS 316
12	STEM O-RING	1	VITON

Output drawing: A4

1 : 1.13 (mm)



6BC-SW-SS

3RD ANGLE		HAM-LET MOTOYAMA JAPAN			
		Member of HAM-LET Group			
CHECKED		DATE	2011/11/22	TYPE	
DESIGNER		SCALE		ITEM NO.	6BC-SW-SS
DRAWN	P.R.Wan	DESCRIBE			